

# Powerful performance, affordable printing

The TASKalfa PA4500ci is the ideal A4 colour printer if your business is searching for a solution that offers low running costs while providing unprecedented productivity and durability. Built with a compact design, this versatile device offers optional Wi-Fi Direct functionality for easy user connection.

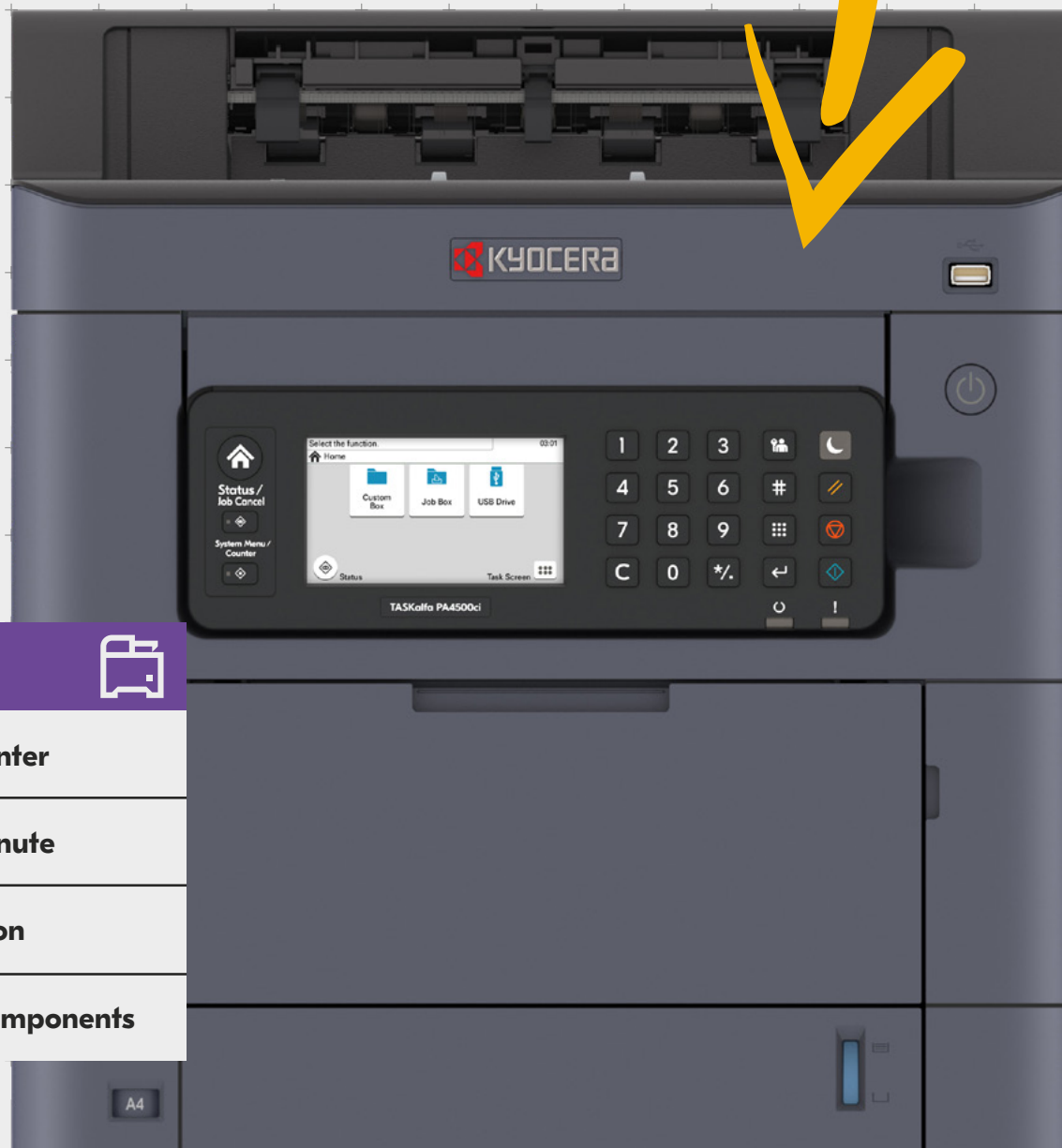

**TASKalfa PA4500ci**



**A4 colour and b/w printer**

**Up to 45 pages per minute**

**Low power consumption**

**Made with long-life components**

A4

## Specifications

### GENERAL

KYOCERA TASKalfa Laser Colour Multifunctional HyPAS™ solution platform  
**Operation panel:** 109.2 mm ( 4.3-inch) full-colour touch panel display  
**Type:** Desktop  
**Engine speed Simplex:** Up to 45 pages A4 per minute  
**Engine speed Duplex:** Up to 37 pages A4 per minute  
**Resolution:** 1,200 × 1,200 dpi print at reduced speed  
**Warm-up time:** Approx. 20 seconds or less  
**Time to first print:** Approx. 5.1/6.2 seconds or less in Monochrome/Colour  
**CPU:** ARM Cortex-A9 Dual core 1.2GHz  
**Memory:** Standard 1GB  
Max. 3GB + 64GB SSD / 256GB SSD / 512GB SSD  
**Standard interfaces:** USB 2.0 (Hi-Speed), 2 x USB Host Interface, Gigabit Ethernet (10BASE-T/100BASE-TX/1000BASE-T), optional Wireless LAN (IEEE 802.11b/g/n), 1 x eKUIO slot for optional devices other than FAX, Slot for optional SD Card  
**Integrated accounting:** 100 department codes  
**Dimensions (W x D x H):** Without packaging: 394 × 531.5 × 455 mm (without protrusions)  
**Weight:** Without packaging: Approx. 34 kg (with bundled toner)  
**Power source:** AC 220 ~ 240 V, 50/60 Hz  
**Power consumption:**  
Printing: 593.8 W  
Ready mode: 12.8 W  
Sleep-mode: 0.5 W (default)

### PAPER HANDLING

All paper capacities quoted are based on paper thickness of max. 0.11 mm. Please use paper recommended by KYOCERA under normal environmental conditions.  
**Input capacity:** Multi-purpose tray: 100 sheets (75 g/m<sup>2</sup> equivalent), 60 – 220 g/m<sup>2</sup>; A4, A5, A6, B5, B6, Letter, Legal, Folio, Custom (70 x 140 to 216 x 356 mm), Banner paper up to 1220 mm  
**Standard universal paper cassette:** 550 sheet with 75 g/m<sup>2</sup>, 60 – 220 g/m<sup>2</sup>; A4, A5, A6, B5, B6, Letter, Legal, Folio, Custom (105 x 140 to 216 x 356 mm)  
**Max. input capacity with options:**  
2,850 sheets with 75 g/m<sup>2</sup>, 3,110 sheets with 64 g/m<sup>2</sup>  
**Duplex:** Standard duplex unit; 60–163 g/m<sup>2</sup>; A4(Legal) - A6R(StatementE)  
**Output capacity:** 500 sheets (Equivalent to 80 g/m<sup>2</sup>) face down with paper full sensor

### PRINT FUNCTIONS

**Controller language:** PRESCRIBE  
**Emulations:** PCL6 (5c/XL), KPDL3 (PostScript 3 compatible), PDF, XPS, Open XPS, TIFF, JPEG, URF, PWG Raster, PCLm  
**Operating systems:** All current Windows operating systems, MAC OS X Version 10.9 or higher, Chrome OS, Linux, as well as other operating systems on request  
**Fonts/barcodes:** 93 outline fonts (PCL6, KPDL3), 4 fonts (Calibri), 4 fonts (Cambria), 1 Bitmap font, 45 types of one-dimensional barcodes, 1 type of two-dimensional barcode (PDF417)  
**Print features:** Encrypted PDF Direct Print, IPP printing, e-mail printing, WSD print, secure printing via SSL, IPsec, SNMPv3, quick copy, proof and hold, private print, job storage and job management functionality  
**Mobile printing support:** KYOCERA Mobile Print app for iOS and Android, AirPrint, Mopria, Microsoft Universal Print, Wi-Fi Direct (Opt)

### CONSUMABLES

Average continuous toner yield in accordance with 5% coverage  
**Toner Kit:**  
TK-5429K: Microfine toner black for 20,000 pages A4  
TK-5419Y, TK-5419M, TK-5419C: Microfine toner Yellow, Magenta, Cyan for 13,000 pages A4;  
Starter toner black 8,000 pages and Yellow, Magenta and Cyan 6,000 pages in A4

### OPTIONS

**PF-5150 Paper feeder:** Max. 550 sheet with 75 g/m<sup>2</sup>, 60 - 220 g/m<sup>2</sup>, ASR - Legal, 92.1 × 165.1 (Com6)  
**1244/10 Cabinet:** for 2-draw configuration  
**Memory upgrade:** 1 GB/2 GB  
**Storage Devices for easy document management:**  
HD-17 SSD hard disk: 64GB  
HD-18 SSD hard disk: 256GB  
HD-19 SSD hard disk: 512GB

### SECURITY OPTIONS

**UG-33 AC:** ThinPrint support  
**UG-35:** TPM (Trusted Platform Module)  
**USB IC Card Reader + Card Authentication Kit (B):** Support for various authentication keys available.  
**CRH 12:** Card Reader Holder 12  
**Optional interface:**  
**IB-37:** Wireless LAN (802.11a/b/g/n/ac) with Wi-Fi Direct  
**IB-50:** Wireless LAN Interface (802.11b/g/n)  
**IB-51:** Wireless LAN Interface (802.11b/g/n)

Specifications and design are subject to change without notice. For the latest on connectivity visit [kyoceradocumentsolutions.us](http://kyoceradocumentsolutions.us). TASKalfa, PRESCRIBE, Kyocera Net Manager, Kyocera Net Viewer, Kyocera Device Manager, PDF Direct Print, Command Center RX, and KX Driver are trademarks of The Kyocera Companies. Mac OS and AirPrint are trademarks of Apple, Inc. Windows is a trademark of Microsoft, Inc. All other trademarks are the property of their respective owners.

HyPAS™



KYOCERA Document Solutions Partner

AGU2023PA4500ci/VER1.0



**Brisbane Business Equipment**

Unit 1, 747 Fairfield Road,  
Yerrongpilly 4105

**Ph (07) 32559500**

email: [sales@bbe.net.au](mailto:sales@bbe.net.au)

\* KYOCERA Document Solutions does not warrant that any specifications mentioned will be error-free. Specifications are subject to change without notice. Information is correct at time of going to press. All other brand and product names may be registered trademarks or trademarks of their respective holders and are hereby acknowledged.  
\*\* Depending on the country